

# 热敏传感器

# THERMISTOR SENSORS

## 汽车

## Automotive products

### 油温传感器

### Oil Temperature Sensor

TOL-56

TOL-56

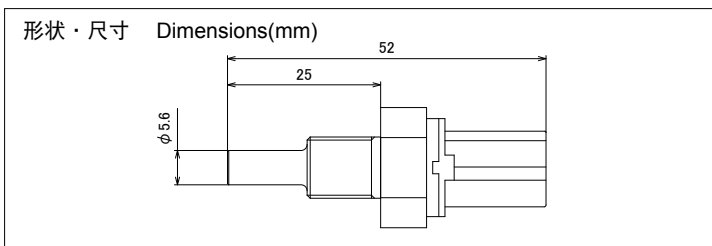
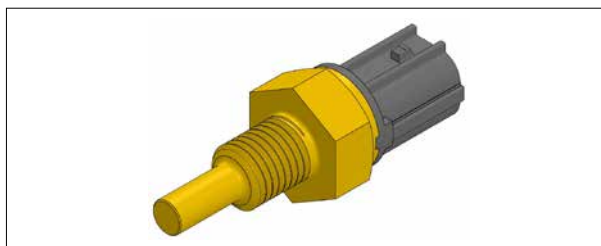

- 使用温度范围 ..... -30°C~+200°C(传感器部位)
- 电阻值 .....  $R_{100}=0.2156k\Omega$
- B值 .....  $B_{50/100}=3456K$
- 热响应时间常数 .....  $\tau=6sec$ (搅拌水中)

- Operating temperature ..... -30°C~+200°C(sensor portion)
- Resistance .....  $R_{100}=0.2156k\Omega$
- B-Value .....  $B_{50/100}=3456K$
- Thermal constant .....  $\tau=6sec$ (in stirred water)

特性、连接器形状变更等可应对客户要求。

Shape, characteristics, among others is customizable.

#### ■特点

#### ■Features

- 防水连接器一体化传感器
- 温度检测精度高
- 响应快 (6sec)
- 耐热性高 (传感器部位200°C)
- 耐严苛的温度循环冲击和振动
- 双重成形技术实现优异的气密性

- Integrated waterproof connector sensor
- Precise temperature measuring
- Quick response (6 sec)
- Durable at high temperature (sensor portion 200°C)
- Tough against extreme heat cycling and vibration
- Double molding makes for airtight construction

#### ■用途

#### ■Applications

- 使用于控制摩托车、汽车的F1 (电子燃料喷射) 系统
- 检测发动机油的温度
- 使用于检测其他产业、住宅设施的水和油的温度

- Electronic fuel injection for motorcycles or automobiles
- Measuring oil temperature
- Measuring liquid temperature for industrial or household applications

### 水温传感器

### Coolant Temperature Sensor

TWT-56

TWT-56

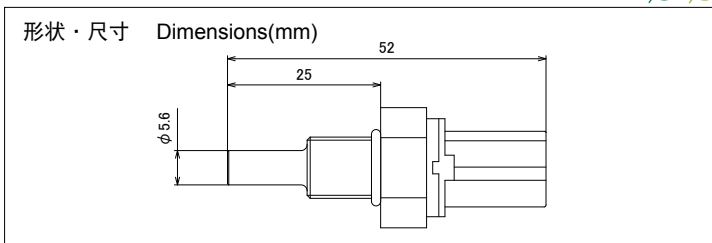
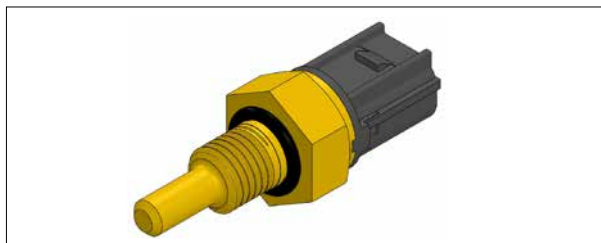

- 使用温度范围 ..... -30°C~+120°C (传感器部位)
- 电阻值 .....  $R_{100}=0.156k\Omega$
- B值 .....  $B_{50/100}=3824K$
- 热响应时间常数 .....  $\tau=6sec$  (搅拌水中)

- Operating temperature ..... -30°C~+120°C(sensor portion)
- Resistance .....  $R_{100}=0.156k\Omega$
- B-Value .....  $B_{50/100}=3824K$
- Thermal constant .....  $\tau=6sec$ (in stirred water)

特性、连接器形状变更等可应对客户要求。

Shape, characteristics, among others is customizable.

#### ■特点

#### ■Features

- 防水连接器一体化传感器
- 温度检测精度高
- 响应快 (6sec)
- 耐严苛的温度循环冲击和振动
- 双重成形技术实现优异的气密性

- Integrated waterproof connector sensor
- Precise temperature measuring
- Quick response (6 sec)
- Tough against extreme heat cycling and vibration
- Double molding makes for airtight construction

#### ■用途

#### ■Applications

- 使用于控制摩托车、汽车的F1 (电子燃料喷射) 系统
- 检测发动机冷却水的温度
- 使用于检测其他产业、住宅设施的水和油的温度

- Electronic fuel injection for motorcycles or automobiles
- Measuring coolant temperature
- Measuring liquid temperature for industrial or household applications