

热敏传感器

THERMISTOR SENSORS



白色家电

用于空调热交换器

ACH-40/42/45/60

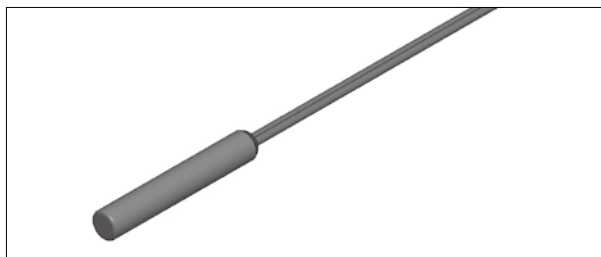

ACH-40/42/45/60

- 电阻值 $R_{25}=10k\Omega \pm 3\%$
- B值(3T) $B_{25/50}=3950K \pm 2\%$
 $B_{25/85}=3989K$
- 使用温度范围 $-30^{\circ}C \sim +100^{\circ}C$
- 热响应时间常数(水中)..... ACH-40,42 : 4.5sec.
ACH-45 : 5sec.
ACH-60 : 10sec.

■特点

- 防湿性能优异。
- 小型、温度响应快。

※关于R-T数据, 请参阅本公司网站。
※有关热敏温度传感器的使用环境条件, 请与本公司协商。

Home Appliance

For Heat Exchanger of Air conditioner

ACH-40/42/45/60



形状・尺寸 Dimensions(mm)

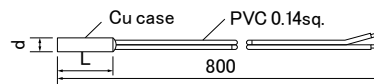

d (mm)	φ 4.0	φ 4.2	φ 4.5	φ 6.0
L (mm)	24	25	25	24

- Resistance $R_{25}=10k\Omega \pm 3\%$
- B value (3T) $B_{25/50}=3950K \pm 2\%$
 $B_{25/85}=3989K$
- Operating temperature range $-30^{\circ}C \sim +100^{\circ}C$
- Thermal time constant (in water) ... ACH-40,42 : 4.5sec.
ACH-45 : 5sec.
ACH-60 : 10sec.

■Features

- Moisture resistant.
- Small with quick temperature response.

※Regarding R-T data, please refer to our web site.
※Please consult us regarding the operating conditions of Thermistor sensors.